



MORE THAN COATINGS AND SYSTEMS.
SUSTAINABLE SOLUTIONS.

ROOF MATE

Sustainable roof coating forms a durable waterproofing membrane designed to extend the life of virtually any new or existing roof substrate.

- Reflects 85+% of the sun's rays
- Dramatically reduces interior temperatures
- Monolithic, liquid-applied; no seams or fasteners
- Fully sustainable 5, 10 and 15 year warranties
- Apply to virtually any roof substrate
- Reduces "Heat Island" effect
- Tax deductible as a maintenance expense
- UL, FM, CRRC, ENERGY STAR® listed
- Miami-Dade County Product Control Approved
NOA 09-0223.11
Expiration Date 04/01/14
- Classified cool construction material

Quest Construction Products
2810 S. 18th Place
Phoenix, AZ 85034
Phone: 480.754.8900
Toll Free: 800-541-4383
Fax: 480.754.8939
www.questconstructionproducts.com

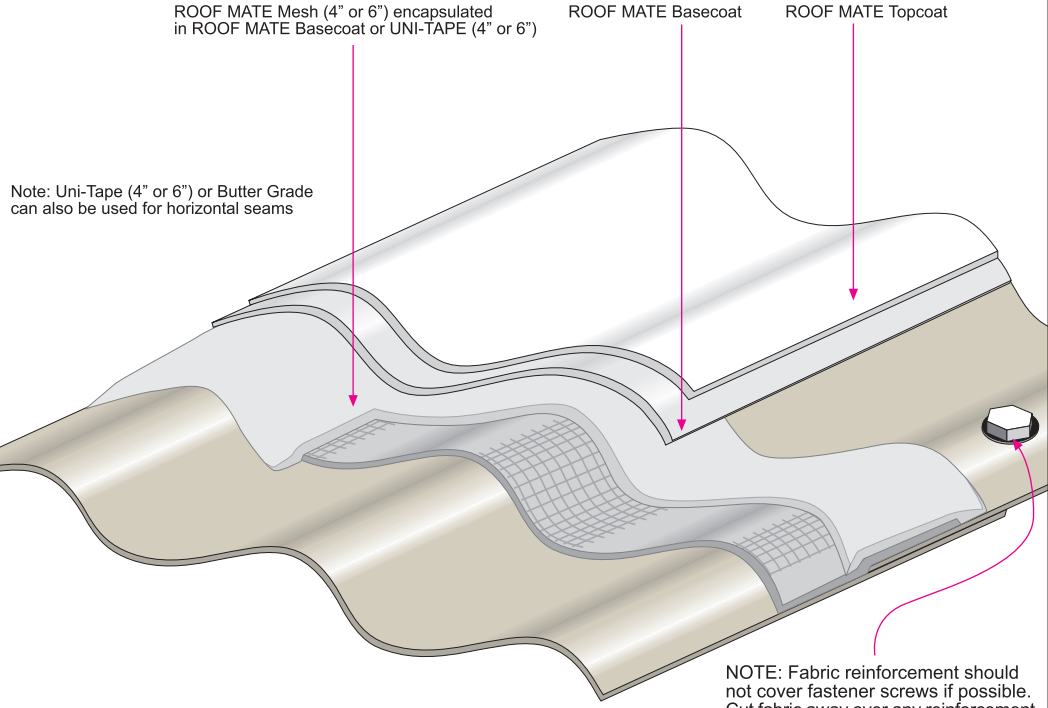

Title:
ROOF MATE
Corrugated Metal Horizontal End-Lap Seam
Version: 01 Supersedes 04/18/06 Date: 06/14/07



MORE THAN COATINGS AND SYSTEMS.
SUSTAINABLE SOLUTIONS.

ROOF MATE

Sustainable roof coating forms a durable waterproofing membrane designed to extend the life of virtually any new or existing roof substrate.

- Reflects 85+% of the sun's rays
- Dramatically reduces interior temperatures
- Monolithic, liquid-applied; no seams or fasteners
- Fully sustainable 5, 10 and 15 year warranties
- Apply to virtually any roof substrate
- Reduces "Heat Island" effect
- Tax deductible as a maintenance expense
- UL, FM, CRRC, ENERGY STAR® listed
- Miami-Dade County Product Control Approved
NOA 09-0223.11
Expiration Date 04/01/14
- Classified cool construction material

Quest Construction Products
2810 S. 18th Place
Phoenix, AZ 85034
Phone: 480.754.8900
Toll Free: 800-541-4383
Fax: 480.754.8939
www.questconstructionproducts.com

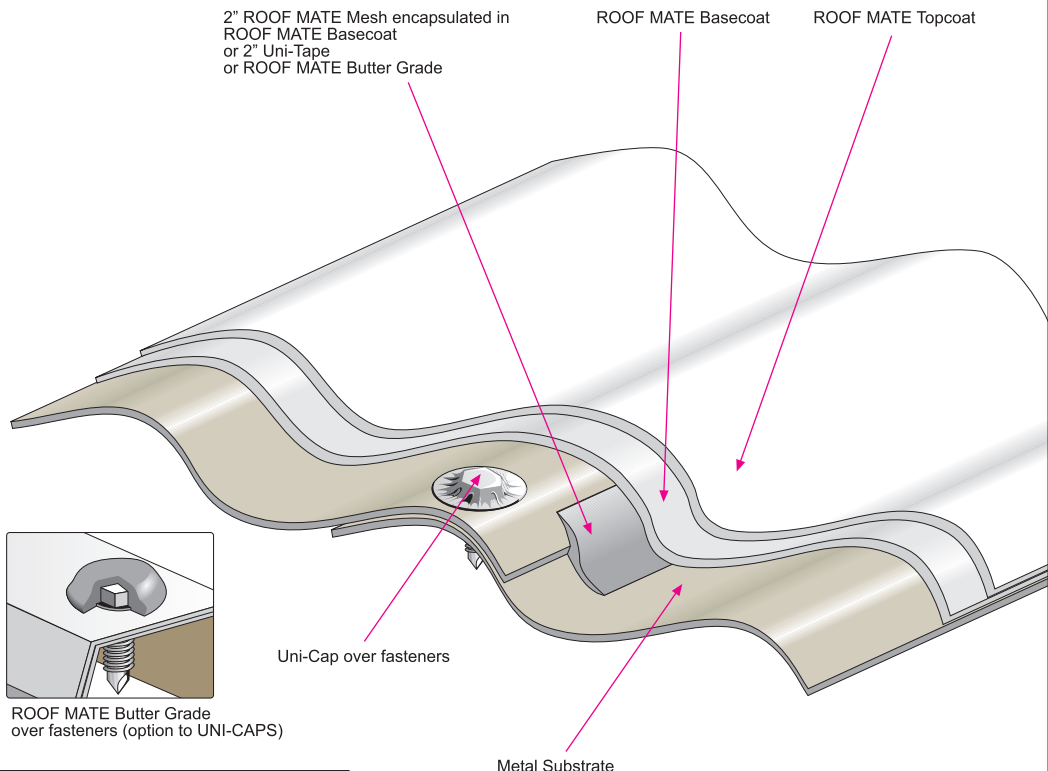

Title:
ROOF MATE
Corrugated Metal Vertical Side-Lap Seam
Version: 01 Supersedes 04/18/06 Date: 06/14/07



MORE THAN COATINGS AND SYSTEMS.
SUSTAINABLE SOLUTIONS.

ROOF MATE

Sustainable roof coating forms a durable waterproofing membrane designed to extend the life of virtually any new or existing roof substrate.

- Reflects 85+% of the sun's rays
- Dramatically reduces interior temperatures
- Monolithic, liquid-applied, no seams or fasteners
- Fully sustainable 5, 10 and 15 year warranties
- Apply to virtually any roof substrate
- Reduces "Heat Island" effect
- Tax deductible as a maintenance expense
- UL, FM, CRRC, ENERGY STAR® listed
- Miami-Dade County Product Control Approved
NOA 09-0223.11
Expiration Date 04/01/14
- Classified cool construction material

Quest Construction Products
2810 S. 18th Place
Phoenix, AZ 85034
Phone: 480.754.8900
Toll Free: 800-541-4383
Fax: 480.754.8939
www.questconstructionproducts.com

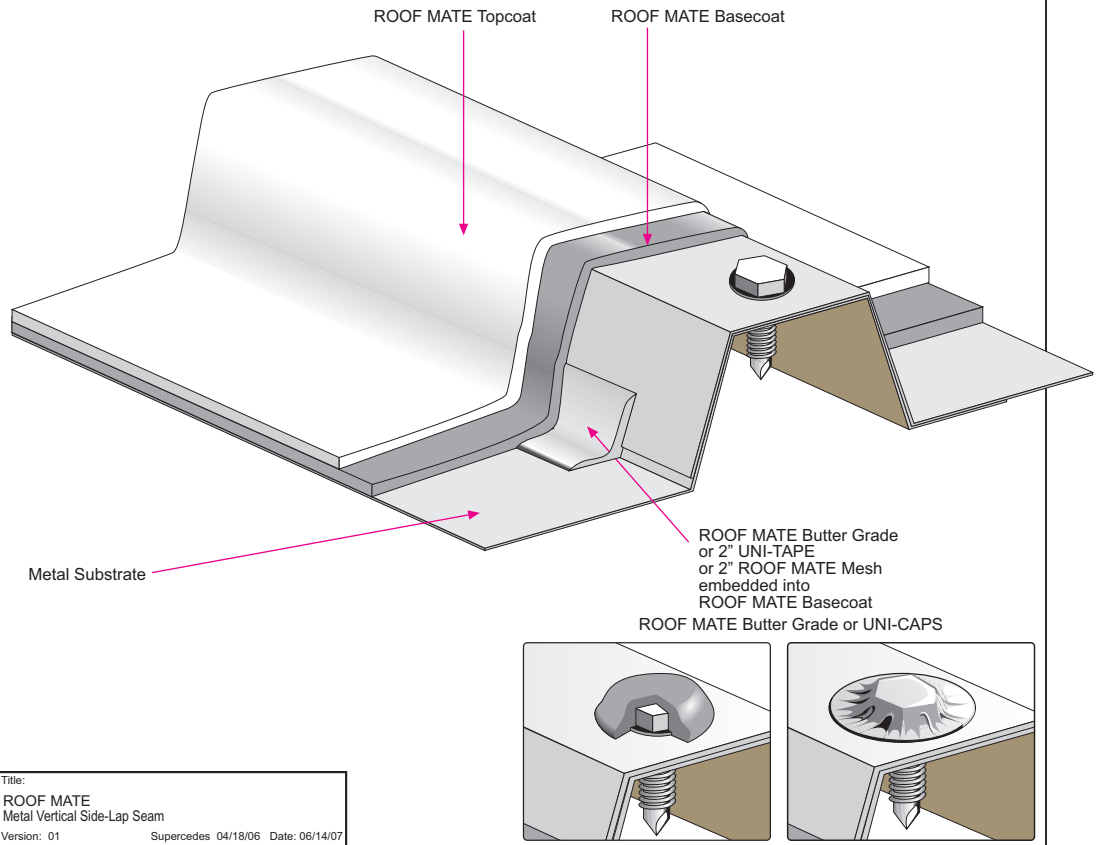

MORE THAN COATINGS AND SYSTEMS.
SUSTAINABLE SOLUTIONS.

ROOF MATE

Sustainable roof coating forms a durable waterproofing membrane designed to extend the life of virtually any new or existing roof substrate.

- Reflects 85+% of the sun's rays
- Dramatically reduces interior temperatures
- Monolithic, liquid-applied; no seams or fasteners
- Fully sustainable 5, 10 and 15 year warranties
- Apply to virtually any roof substrate
- Reduces "Heat Island" effect
- Tax deductible as a maintenance expense
- UL, FM, CRRC, ENERGY STAR® listed
- Miami-Dade County Product Control Approved
NOA 09-0223.11
Expiration Date 04/01/14
- Classified cool construction material

Quest Construction Products
2810 S. 18th Place
Phoenix, AZ 85034
Phone: 480.754.8900
Toll Free: 800-541-4383
Fax: 480.754.8939
www.questconstructionproducts.com

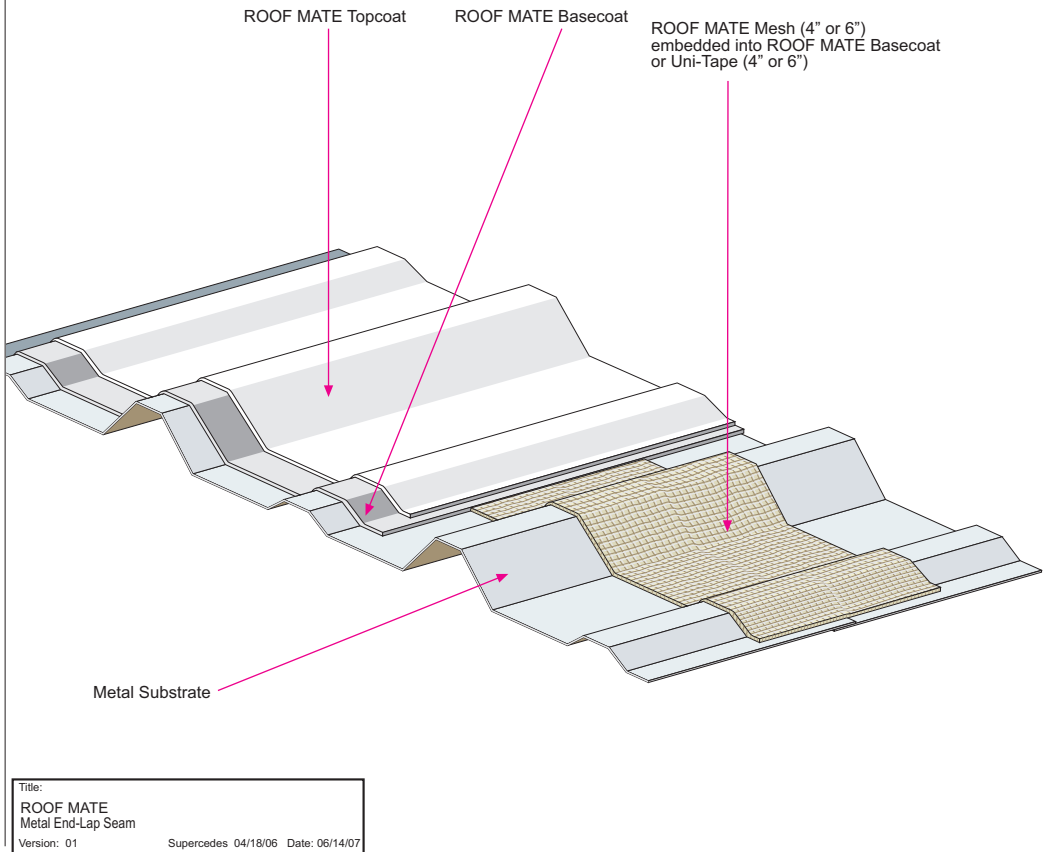



MORE THAN COATINGS AND SYSTEMS.
SUSTAINABLE SOLUTIONS.

ROOF MATE

Sustainable roof coating forms a durable waterproofing membrane designed to extend the life of virtually any new or existing roof substrate.

- Reflects 85+% of the sun's rays
- Dramatically reduces interior temperatures
- Monolithic, liquid-applied; no seams or fasteners
- Fully sustainable 5, 10 and 15 year warranties
- Apply to virtually any roof substrate
- Reduces "Heat Island" effect
- Tax deductible as a maintenance expense
- UL, FM, CRRC, ENERGY STAR® listed
- Miami-Dade County Product Control Approved
NOA 09-0223.11
Expiration Date 04/01/14
- Classified cool construction material

Quest Construction Products
2810 S. 18th Place
Phoenix, AZ 85034
Phone: 480.754.8900
Toll Free: 800-541-4383
Fax: 480.754.8939
www.questconstructionproducts.com

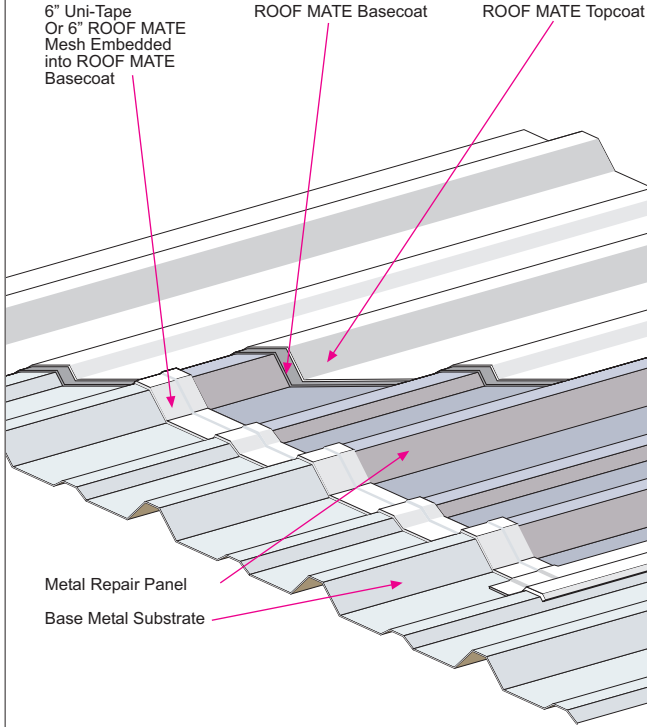

Title: ROOF MATE Metal Repair
Version: 01 Supercedes 04/18/06 Date: 06/14/07



MORE THAN COATINGS AND SYSTEMS.
SUSTAINABLE SOLUTIONS.

ROOF MATE

Sustainable roof coating forms a durable waterproofing membrane designed to extend the life of virtually any new or existing roof substrate.

- Reflects 85+% of the sun's rays
- Dramatically reduces interior temperatures
- Monolithic, liquid-applied; no seams or fasteners
- Fully sustainable 5, 10 and 15 year warranties
- Apply to virtually any roof substrate
- Reduces "Heat Island" effect
- Tax deductible as a maintenance expense
- UL, FM, CRRC, ENERGY STAR® listed
- Miami-Dade County Product Control Approved
NOA 09-0223.11
Expiration Date 04/01/14
- Classified cool construction material

Quest Construction Products
2810 S. 18th Place
Phoenix, AZ 85034
Phone: 480.754.8900
Toll Free: 800-541-4383
Fax: 480.754.8939
www.questconstructionproducts.com

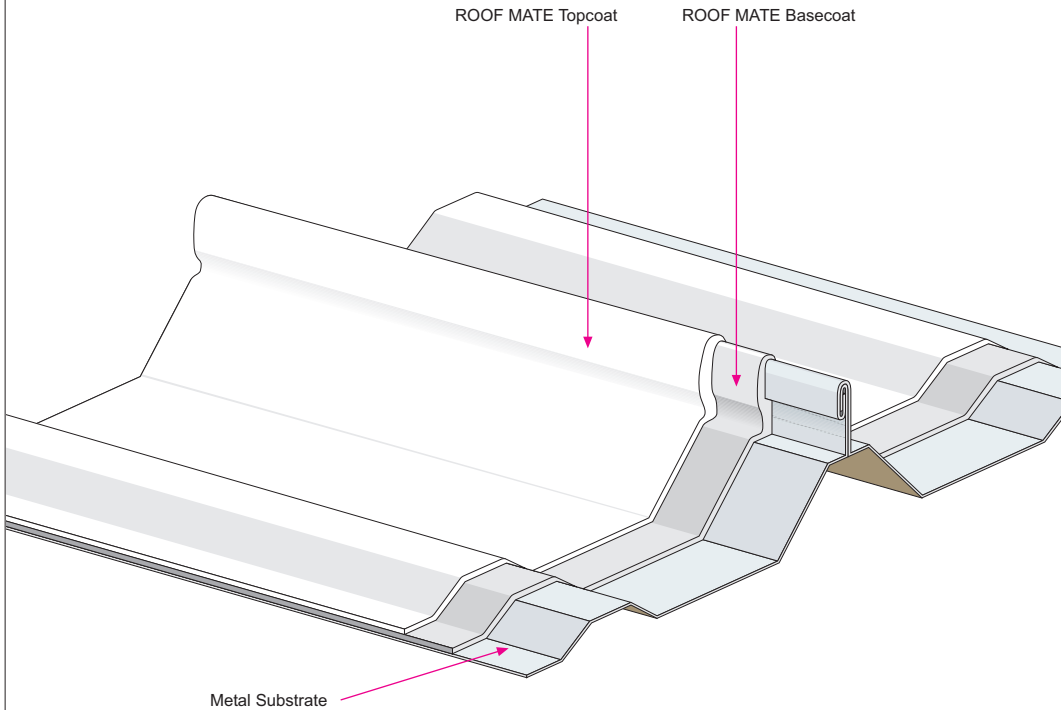

Title: ROOF MATE Rolled Metal Seam w/ Basecoat & Topcoat
Version: 01 Supercedes 04/18/06 Date: 06/14/07



MORE THAN COATINGS AND SYSTEMS.
SUSTAINABLE SOLUTIONS.

ROOF MATE

Sustainable roof coating forms a durable waterproofing membrane designed to extend the life of virtually any new or existing roof substrate.

- Reflects 85+% of the sun's rays
- Dramatically reduces interior temperatures
- Monolithic, liquid-applied; no seams or fasteners
- Fully sustainable 5, 10 and 15 year warranties
- Apply to virtually any roof substrate
- Reduces "Heat Island" effect
- Tax deductible as a maintenance expense
- UL, FM, CRRC, ENERGY STAR® listed
- Miami-Dade County Product Control Approved
NOA 09-0223.11
Expiration Date 04/01/14
- Classified cool construction material

Quest Construction Products
2810 S. 18th Place
Phoenix, AZ 85034
Phone: 480.754.8900
Toll Free: 800-541-4383
Fax: 480.754.8939
www.questconstructionproducts.com

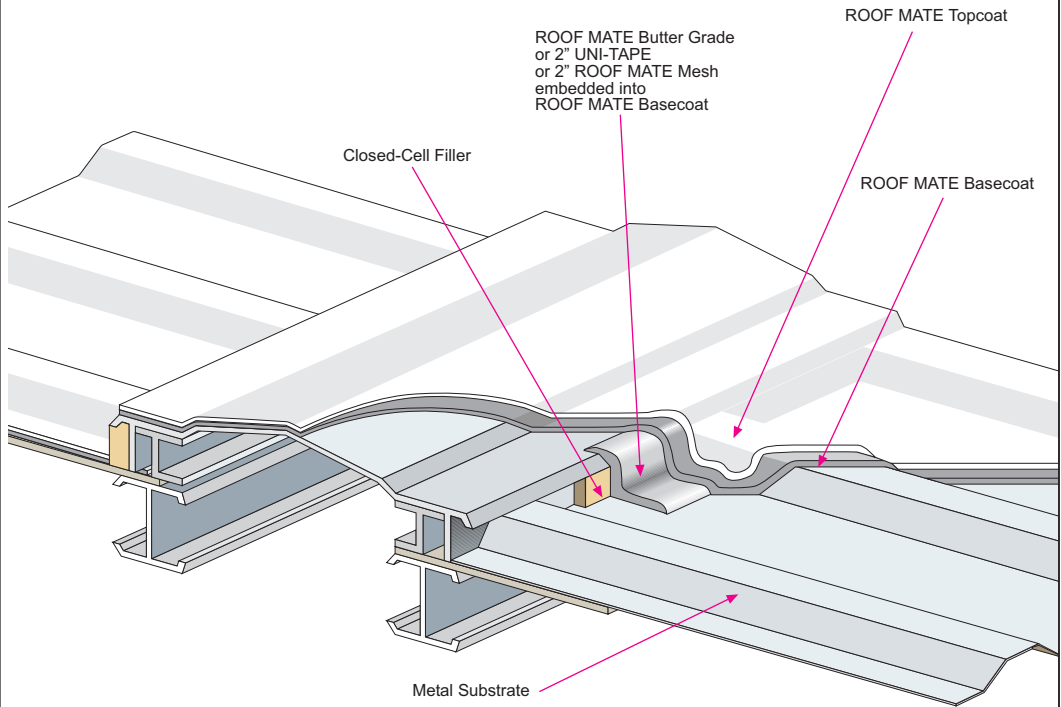

Title:
ROOF MATE
Elevated Metal Ridge Cap
Version: 01 Supercedes 04/18/06 Date: 06/14/07



MORE THAN COATINGS AND SYSTEMS.
SUSTAINABLE SOLUTIONS.

ROOF MATE

Sustainable roof coating forms a durable waterproofing membrane designed to extend the life of virtually any new or existing roof substrate.

- Reflects 85+% of the sun's rays
- Dramatically reduces interior temperatures
- Monolithic, liquid-applied; no seams or fasteners
- Fully sustainable 5, 10 and 15 year warranties
- Apply to virtually any roof substrate
- Reduces "Heat Island" effect
- Tax deductible as a maintenance expense
- UL, FM, CRRC, ENERGY STAR® listed
- Miami-Dade County Product Control Approved
NOA 09-0223.11
Expiration Date 04/01/14
- Classified cool construction material

Quest Construction Products
2810 S. 18th Place
Phoenix, AZ 85034
Phone: 480.754.8900
Toll Free: 800-541-4383
Fax: 480.754.8939
www.questconstructionproducts.com

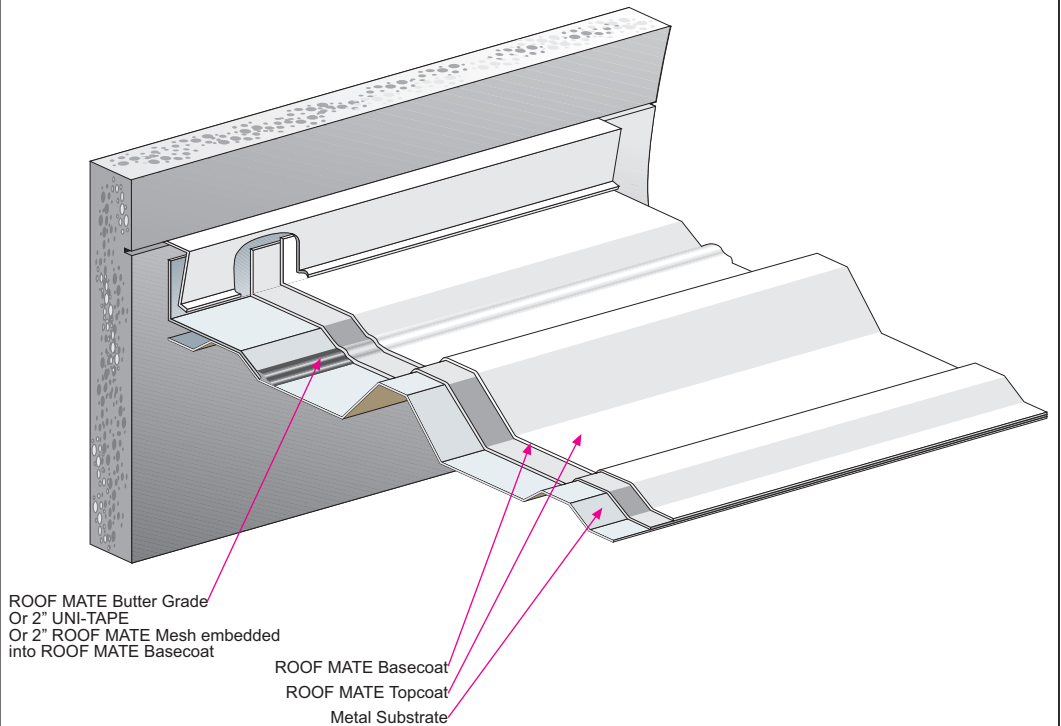

Title:
ROOF MATE
Concrete Parapet Termination w/ Counter-Flashing
Version: 01 Supercedes 04/18/06 Date: 06/14/07



QUEST
CONSTRUCTION PRODUCTS

MORE THAN COATINGS AND SYSTEMS.
SUSTAINABLE SOLUTIONS.

ROOF MATE

Sustainable roof coating forms a durable waterproofing membrane designed to extend the life of virtually any new or existing roof substrate.

- Reflects 85+% of the sun's rays
- Dramatically reduces interior temperatures
- Monolithic, liquid-applied; no seams or fasteners
- Fully sustainable 5, 10 and 15 year warranties
- Apply to virtually any roof substrate
- Reduces "Heat Island" effect
- Tax deductible as a maintenance expense
- UL, FM, CRRC, ENERGY STAR® listed
- Miami-Dade County Product Control Approved
NOA 09-0223.11
Expiration Date 04/01/14
- Classified cool construction material

Quest Construction Products
2810 S. 18th Place
Phoenix, AZ 85034
Phone: 480.754.8900
Toll Free: 800-541-4383
Fax: 480.754.8939
www.questconstructionproducts.com



Title:
ROOF MATE
Cant w/ Counter-Flashing Using Full Fabric System
Version: 01 Supersedes 04/18/06 Date: 06/14/07

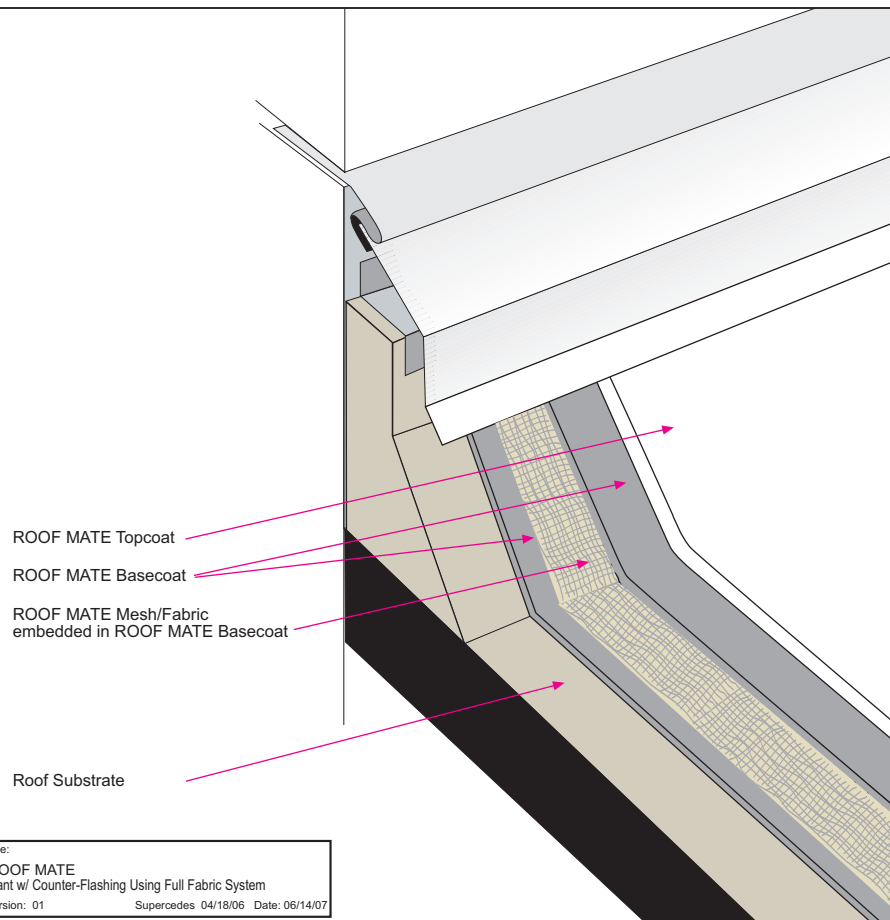

QUEST
CONSTRUCTION PRODUCTS

MORE THAN COATINGS AND SYSTEMS.
SUSTAINABLE SOLUTIONS.

ROOF MATE

Sustainable roof coating forms a durable waterproofing membrane designed to extend the life of virtually any new or existing roof substrate.

- Reflects 85+% of the sun's rays
- Dramatically reduces interior temperatures
- Monolithic, liquid-applied; no seams or fasteners
- Fully sustainable 5, 10 and 15 year warranties
- Apply to virtually any roof substrate
- Reduces "Heat Island" effect
- Tax deductible as a maintenance expense
- UL, FM, CRRC, ENERGY STAR® listed
- Miami-Dade County Product Control Approved
NOA 09-0223.11
Expiration Date 04/01/14
- Classified cool construction material

Quest Construction Products
2810 S. 18th Place
Phoenix, AZ 85034
Phone: 480.754.8900
Toll Free: 800-541-4383
Fax: 480.754.8939
www.questconstructionproducts.com



Title:
ROOF MATE
Metal Facia Cap and Drip Edge
Version: 01 Supersedes 04/18/06 Date: 06/14/07

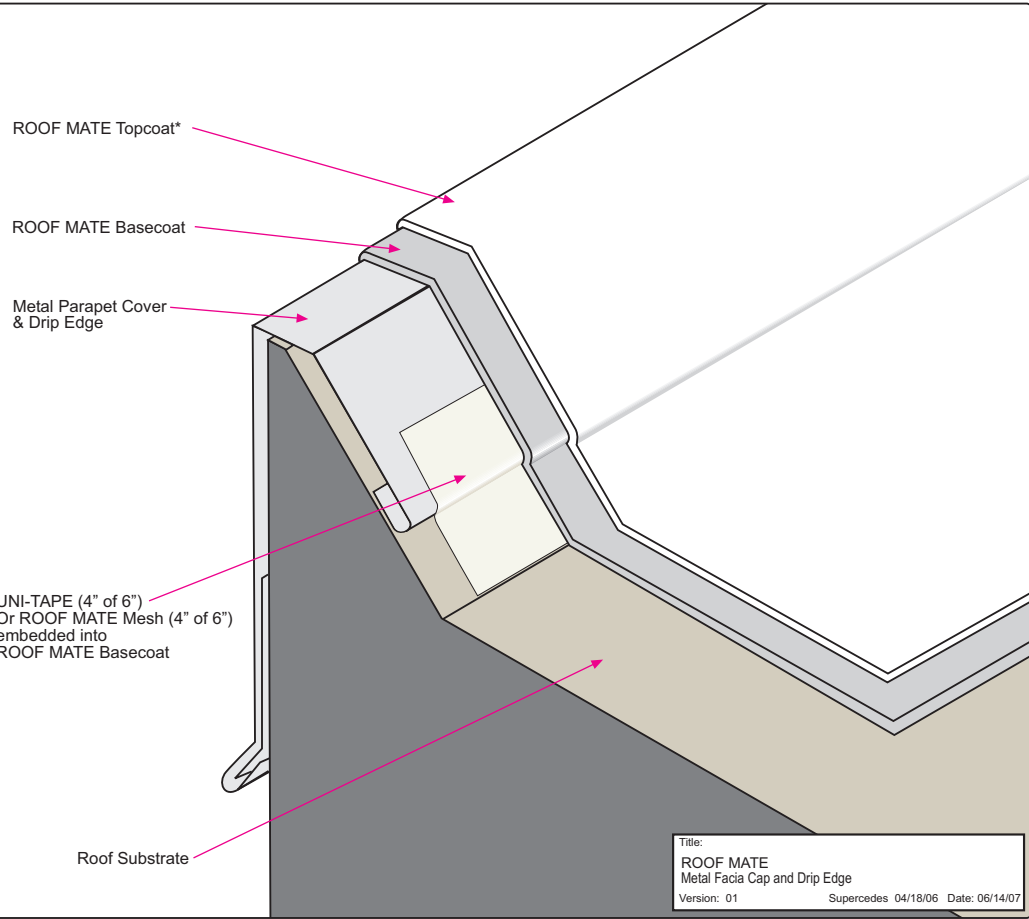



MORE THAN COATINGS AND SYSTEMS.
SUSTAINABLE SOLUTIONS.

ROOF MATE

Sustainable roof coating forms a durable waterproofing membrane designed to extend the life of virtually any new or existing roof substrate.

- Reflects 85+% of the sun's rays
- Dramatically reduces interior temperatures
- Monolithic, liquid-applied; no seams or fasteners
- Fully sustainable 5, 10 and 15 year warranties
- Apply to virtually any roof substrate
- Reduces "Heat Island" effect
- Tax deductible as a maintenance expense
- UL, FM, CRRC, ENERGY STAR® listed
- Miami-Dade County Product Control Approved
NOA 09-0223.11
Expiration Date 04/01/14
- Classified cool construction material

Quest Construction Products
2810 S. 18th Place
Phoenix, AZ 85034
Phone: 480.754.8900
Toll Free: 800-541-4383
Fax: 480.754.8939
www.questconstructionproducts.com



Remove metal ridge cap prior to application of ROOF MATE. Replace after coating has cured. Use new screws positioned at least 1" (2.5 cm) horizontally from the original hole.

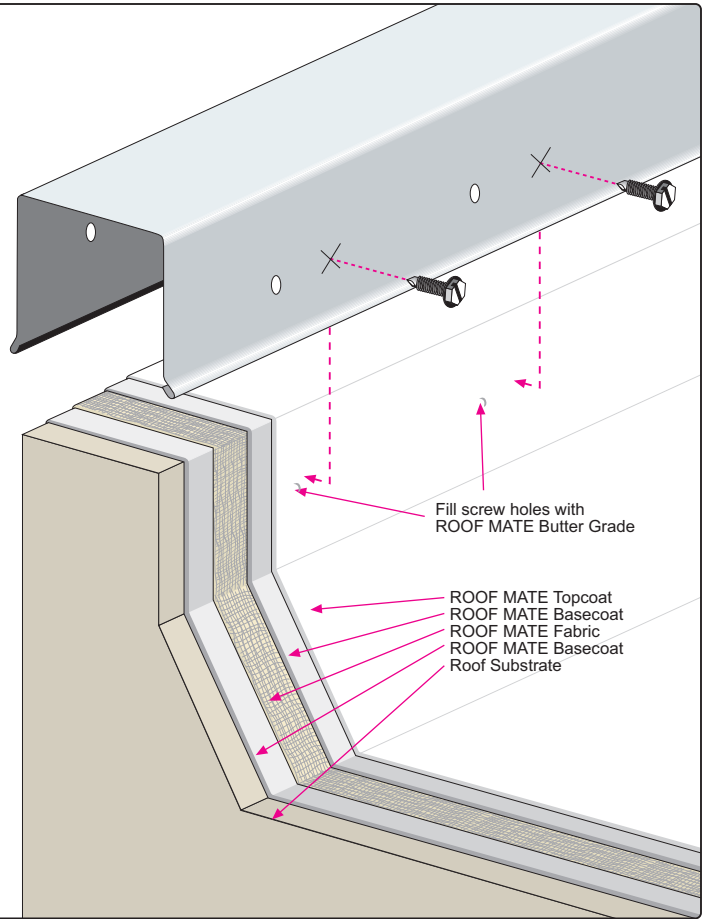

Title: ROOF MATE Parapet Wall w/ Metal Cap
Version: 01 Supersedes 04/18/06 Date: 06/14/07



MORE THAN COATINGS AND SYSTEMS.
SUSTAINABLE SOLUTIONS.

ROOF MATE

Sustainable roof coating forms a durable waterproofing membrane designed to extend the life of virtually any new or existing roof substrate.

- Reflects 85+% of the sun's rays
- Dramatically reduces interior temperatures
- Monolithic, liquid-applied; no seams or fasteners
- Fully sustainable 5, 10 and 15 year warranties
- Apply to virtually any roof substrate
- Reduces "Heat Island" effect
- Tax deductible as a maintenance expense
- UL, FM, CRRC, ENERGY STAR® listed
- Miami-Dade County Product Control Approved
NOA 09-0223.11
Expiration Date 04/01/14
- Classified cool construction material

Quest Construction Products
2810 S. 18th Place
Phoenix, AZ 85034
Phone: 480.754.8900
Toll Free: 800-541-4383
Fax: 480.754.8939
www.questconstructionproducts.com

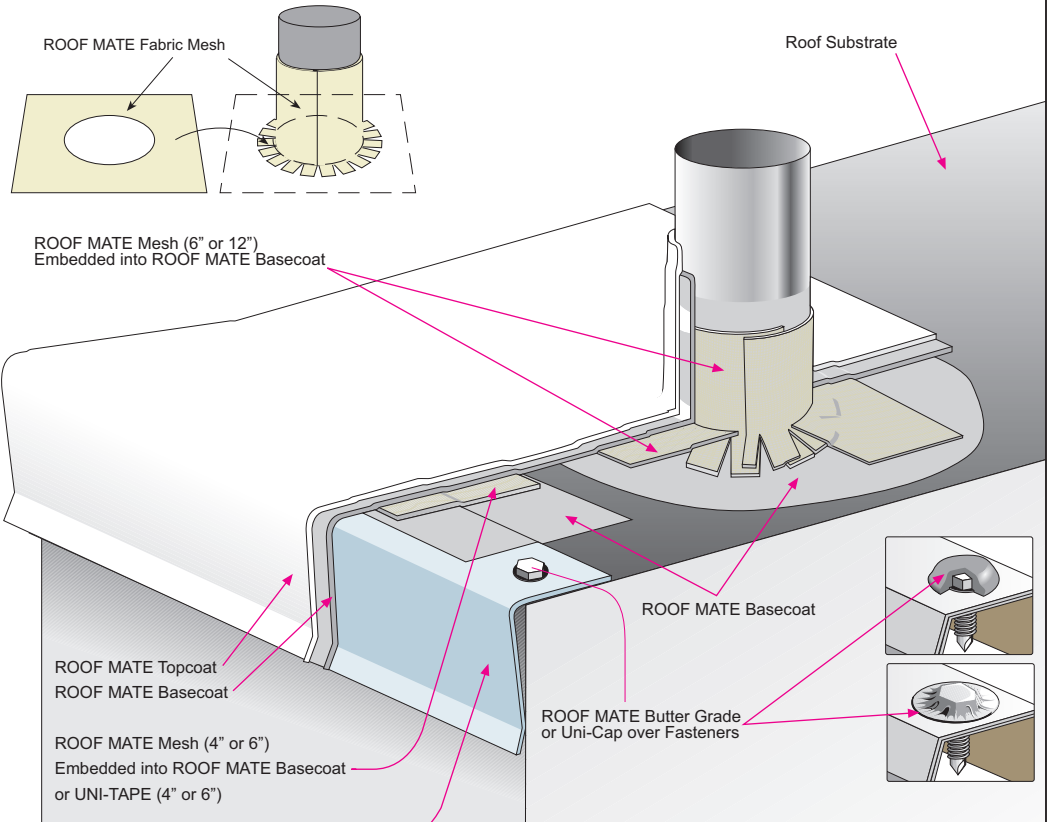

Title: ROOF MATE Pipe Protrusion & Metal Drip Edge
Version: 01 Supersedes 04/18/06 Date: 06/14/07



QUEST
CONSTRUCTION PRODUCTS

MORE THAN COATINGS AND SYSTEMS.
SUSTAINABLE SOLUTIONS.

ROOF MATE

Sustainable roof coating forms a durable waterproofing membrane designed to extend the life of virtually any new or existing roof substrate.

- Reflects 85+% of the sun's rays
- Dramatically reduces interior temperatures
- Monolithic, liquid-applied; no seams or fasteners
- Fully sustainable 5, 10 and 15 year warranties
- Apply to virtually any roof substrate
- Reduces "Heat Island" effect
- Tax deductible as a maintenance expense
- UL, FM, CRRC, ENERGY STAR® listed
- Miami-Dade County Product Control Approved
NOA 09-0223.11
Expiration Date 04/01/14
- Classified cool construction material

Quest Construction Products
2810 S. 18th Place
Phoenix, AZ 85034
Phone: 480.754.8900
Toll Free: 800-541-4383
Fax: 480.754.8939
www.questconstructionproducts.com

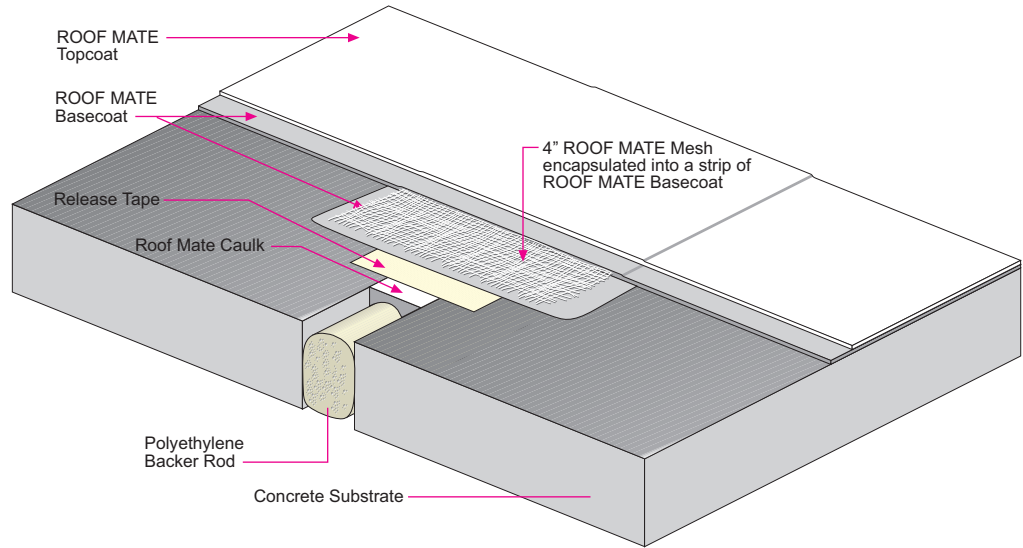

Title:
ROOF MATE
Moving Crack / Control Joint Over Concrete
Version: 01 Supersedes 04/18/06 Date: 06/14/07



QUEST
CONSTRUCTION PRODUCTS

MORE THAN COATINGS AND SYSTEMS.
SUSTAINABLE SOLUTIONS.

ROOF MATE

Sustainable roof coating forms a durable waterproofing membrane designed to extend the life of virtually any new or existing roof substrate.

- Reflects 85+% of the sun's rays
- Dramatically reduces interior temperatures
- Monolithic, liquid-applied; no seams or fasteners
- Fully sustainable 5, 10 and 15 year warranties
- Apply to virtually any roof substrate
- Reduces "Heat Island" effect
- Tax deductible as a maintenance expense
- UL, FM, CRRC, ENERGY STAR® listed
- Miami-Dade County Product Control Approved
NOA 09-0223.11
Expiration Date 04/01/14
- Classified cool construction material

Quest Construction Products
2810 S. 18th Place
Phoenix, AZ 85034
Phone: 480.754.8900
Toll Free: 800-541-4383
Fax: 480.754.8939
www.questconstructionproducts.com

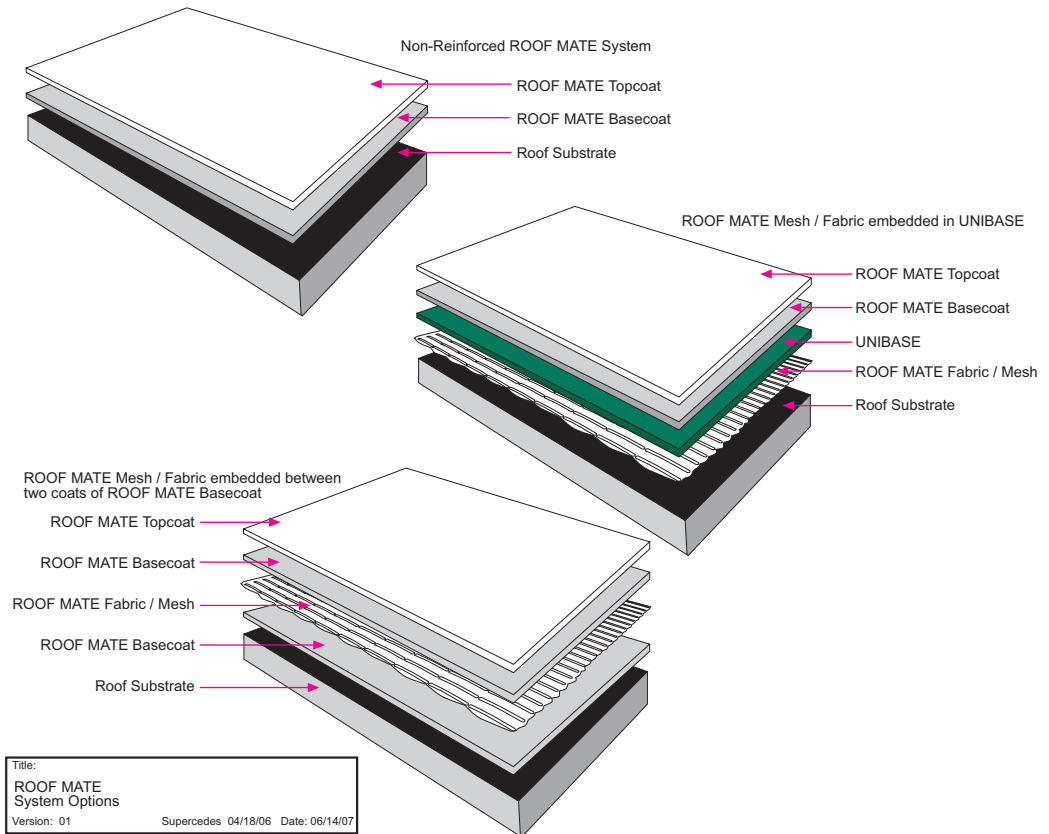

Title:
ROOF MATE
System Options
Version: 01 Supersedes 04/18/06 Date: 06/14/07





QUEST

CONSTRUCTION PRODUCTS

MORE THAN COATINGS AND SYSTEMS.
SUSTAINABLE SOLUTIONS.

ROOF MATE

Sustainable roof coating forms a durable waterproofing membrane designed to extend the life of virtually any new or existing roof substrate.

- Reflects 85+% of the sun's rays
- Dramatically reduces interior temperatures
- Monolithic, liquid-applied; no seams or fasteners
- Fully sustainable 5, 10 and 15 year warranties
- Apply to virtually any roof substrate
- Reduces "Heat Island" effect
- Tax deductible as a maintenance expense
- UL, FM, CRRC, ENERGY STAR® listed
- Miami-Dade County Product Control Approved
NOA 09-0223.11
Expiration Date 04/01/14
- Classified cool construction material

Quest Construction Products
2810 S. 18th Place
Phoenix, AZ 85034
Phone: 480.754.8900
Toll Free: 800-541-4383
Fax: 480.754.8939
www.questconstructionproducts.com



ROOF MATE Fabric cut to size and encapsulated in **ROOF MATE Butter Grade**.

NOTE: It is important to work quickly during this entire detail process. DO NOT allow the butter grade to dry between coats or the fabric will not be properly encapsulated.

STEP 1: Using a 3" to 4" (7.5 to 10 cm) paintbrush, liberally apply a coat of **ROOF MATE Butter Grade** to the entire drain bowl. Extend the butter grade approximately 6" (15 cm) beyond the bowl rim and onto the roof surface in all directions.

STEP 2: While the butter grade is still wet, cut a strip of **ROOF MATE Fabric** long enough to line the interior diameter of the drain bowl with a 1" to 2" (2.5 to 5 cm) overlap. The fabric should be wide enough to fit approximately half way to the bottom of the bowl while also extending 3" to 4" (7.5 to 10 cm) above the bowl rim. Cut the fabric extending above the bowl rim into flanges, flattening them into the wet butter grade with the brush in a pattern extending away from the bowl. Apply additional **ROOF MATE Butter Grade** to completely encapsulate the fabric.

STEP 3: Cut a second, circular piece of **ROOF MATE Fabric** just large enough to cover the drain and fabric flanges of the first piece of fabric. Fold the fabric in half and then in half again to find the center. Use scissors to cut off enough of the point to create a hole in the exact center of the fabric that is not more than 1/2 the diameter of the drain bowl.

STEP 4: Unfold the circular piece of fabric and center it over the drain. Apply additional **ROOF MATE Butter Grade** around the perimeter of the drain if it is not still wet enough to absorb into the fabric. Cut the fabric into flanges extending outward from the center of the hole to the edge of the bowl. Use the brush to smooth the fabric flanges down into the bowl, working out any air pockets or wrinkles. Apply additional butter grade to completely encapsulate the **ROOF MATE Fabric**, extending it 1" to 2" (2.5 to 5 cm) beyond the edge of the fabric around the perimeter of the drain on the roof surface.

STEP 5: Coat over the entire detailed area with **ROOF MATE** basecoat and topcoat as it is applied to the balance of the roof, per project specifications. Refer to appropriate Master Guide Specifications for complete application instructions.

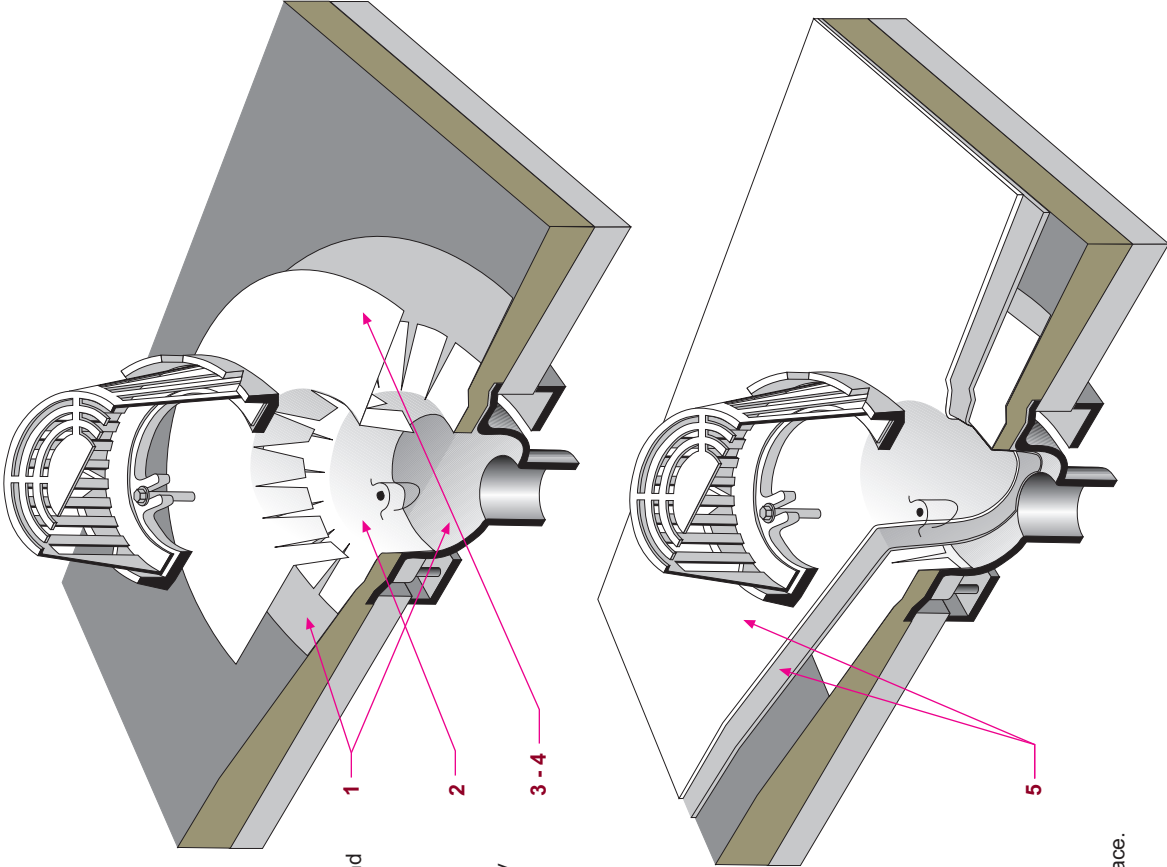

Title:
ROOF MATE
Fabric reinforced drain
Version: 01

Supersedes 04/18/06 Date: 06/14/07



QUEST
CONSTRUCTION PRODUCTS

MORE THAN COATINGS AND SYSTEMS.
SUSTAINABLE SOLUTIONS.

ROOF MATE

Sustainable roof coating forms a durable waterproofing membrane designed to extend the life of virtually any new or existing roof substrate.

- Reflects 85+% of the sun's rays
- Dramatically reduces interior temperatures
- Monolithic, liquid-applied; no seams or fasteners
- Fully sustainable 5, 10 and 15 year warranties
- Apply to virtually any roof substrate
- Reduces "Heat Island" effect
- Tax deductible as a maintenance expense
- UL, FM, CRRG, ENERGY STAR® listed
- Miami-Dade County Product Control Approved
NOA 09-0223.11
Expiration Date 04/01/14
- Classified cool construction material

Quest Construction Products
2810 S. 18th Place
Phoenix, AZ 85034
Phone: 480.754.8900
Toll Free: 800-541-4383
Fax: 480.754.8939
www.questconstructionproducts.com

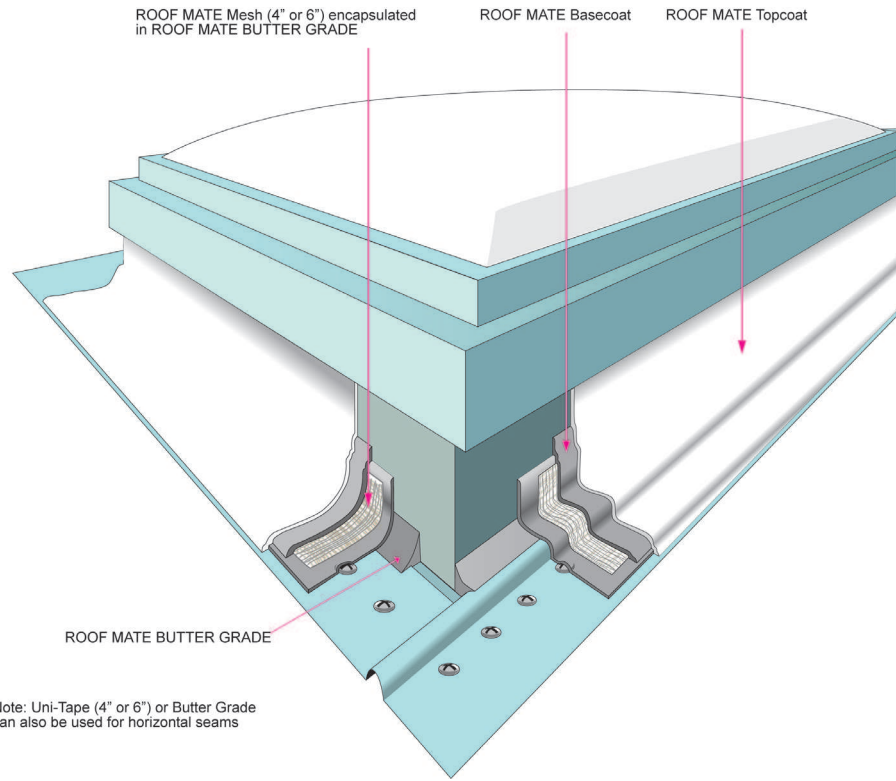

Title:
ROOF MATE
Concrete Parapet Termination w/ Counter-Flashing
Version: 01 Supersedes 04/18/06 Date: 06/14/07